

VILLA NAUTICA

PARADISE ISLAND

JUNE 2023

MEETINGS AND EVENTS

VILLA NAUTICA

Located in North Malé Atoll, just 20 minutes
from Velana International Airport by speedboat.

Villa Nautica celebrates the glitz and glamour of yacht-life and is always 'en vogue'. Surrounded by sparkling lagoons and idyllic beaches, it is an island like no other: a hive of activity, a place to be seen. Complemented by exceptional scuba diving and other water sports, the resort embraces the seafarer lifestyle with a glamorous twist. With diverse indoor event spaces, state-of-the-art technology, and the perfect balance of luxury and functionality, our facilities are well-suited for corporate gatherings, workshops, and retreats. Plus, with our stunning landscapes, world-class amenities, and recreational activities, we offer more than just a meeting place. Turn your brainstorming sessions into beachside encounters or incorporate our watersports and spa treatments to elevate your corporate events.

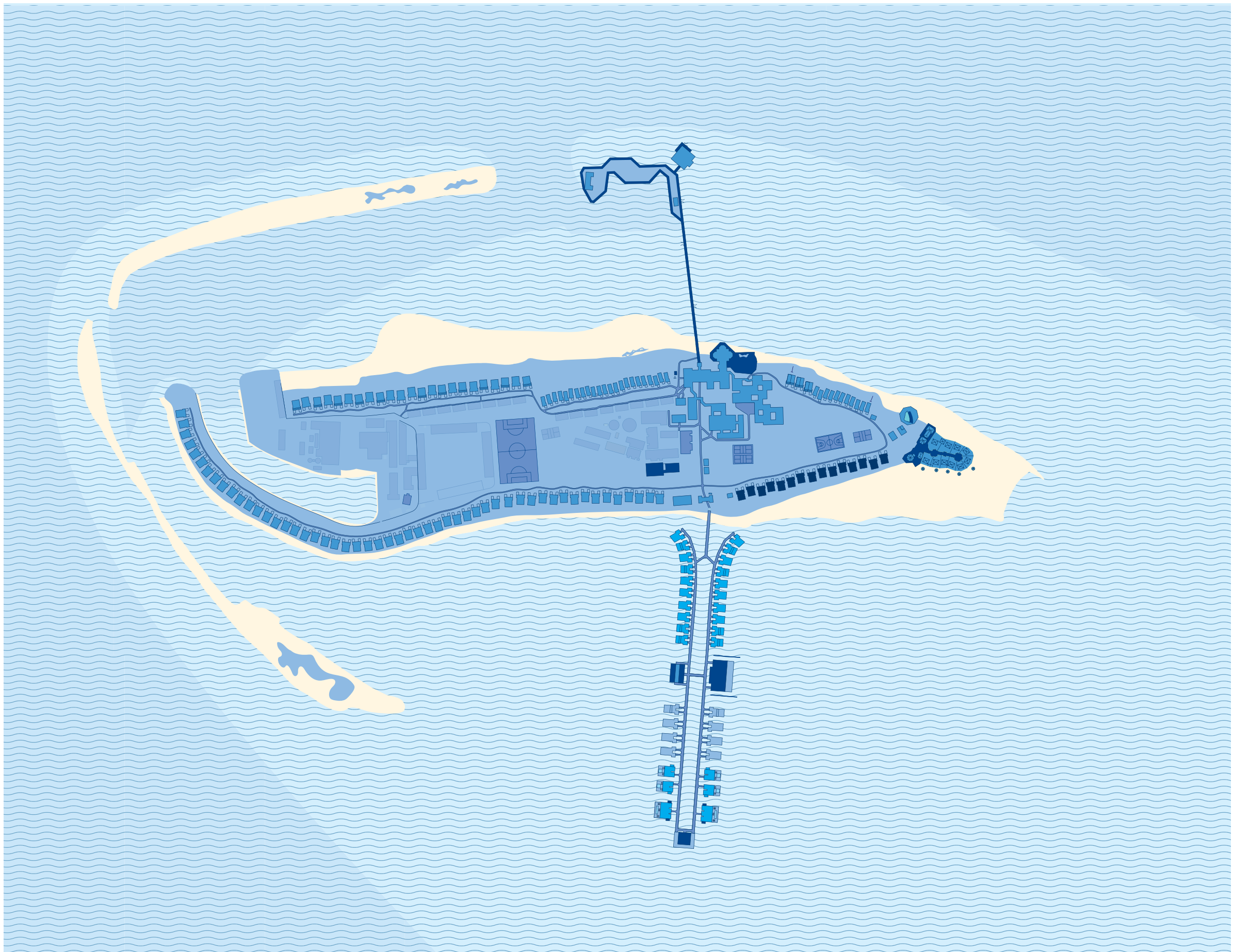

CONFERENCE HALLS

1 - Dhinasha
2 - Burunu

01

DHINASHA

CONFERENCE HALL

A grand display of space and technology, the Dhinasha Conference Hall stands as our largest corporate event space. Capable of accommodating up to 460 guests in a theatre setup, this 343 square meter hall is equipped with video conferencing capabilities, multimedia projectors, wireless internet access, and more, providing an ideal setting for large scale presentations and gatherings.



Video
Conferencing



Wireless
Internet



Multimedia
Projector



Projection
Screen



PA System



LCD TVs



Digital Audio
Recording

Ceiling Height (m): 3.5
Dimension (m): 24.5 x 14
Total Space (sqm): 343

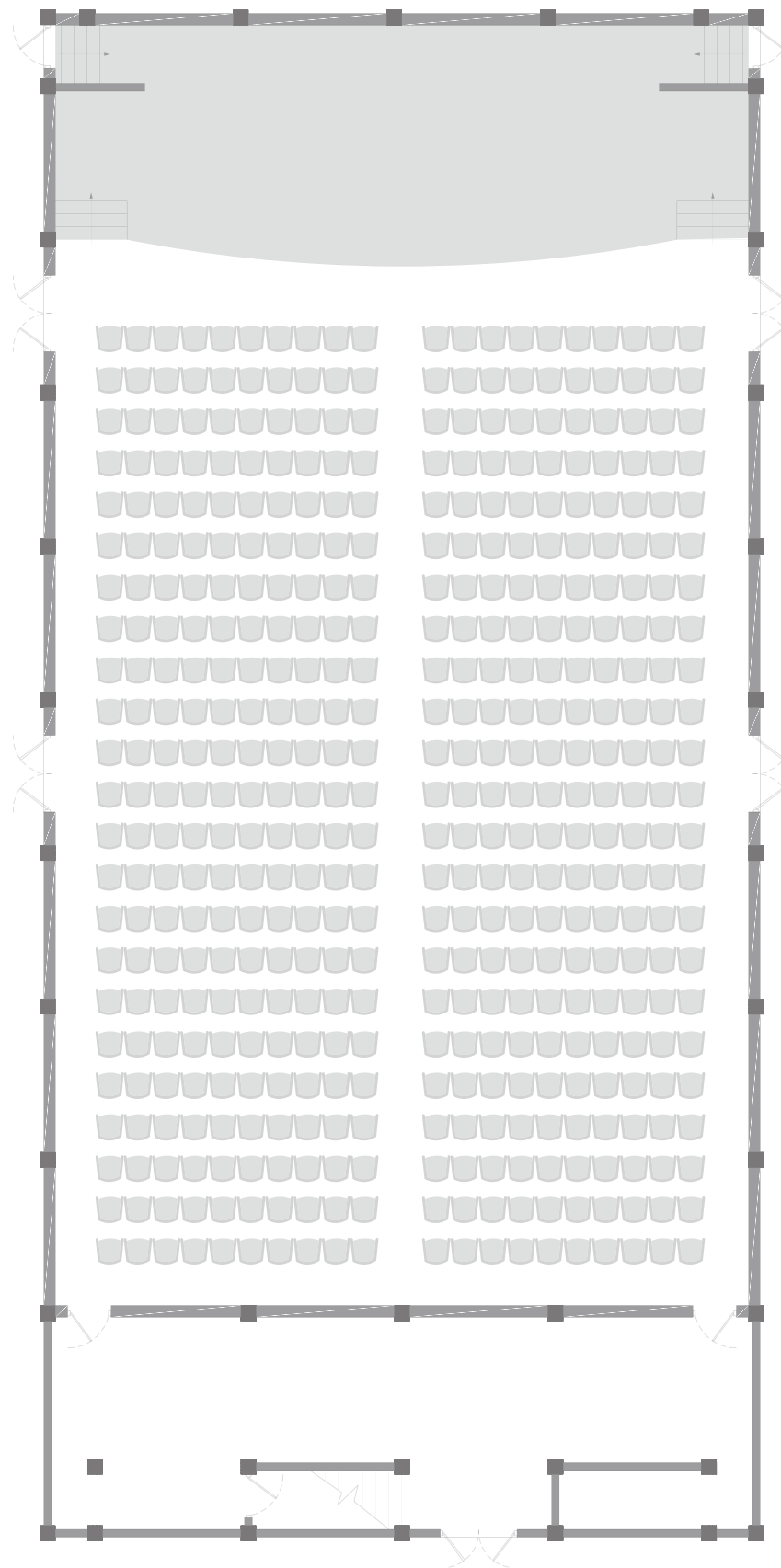

Dhinasha - Conference Hall



BURUNU

CONFERENCE HALL

The Burunu Conference Hall offers a versatile, spacious setting for up to 243 guests. This 201 square meter area is furnished with modern audio-visual equipment, including LCD TVs, PA system, and digital audio, making it a preferred choice for interactive sessions and collaborative events.



Video Conferencing



Wireless Internet



Multimedia Projector



Projection Screen



PA System



LCD TVs



Digital Audio Recording

Ceiling Height (m): 2.6
Dimension (m): 17.5 x 11.5
Total Space (sqm): 201

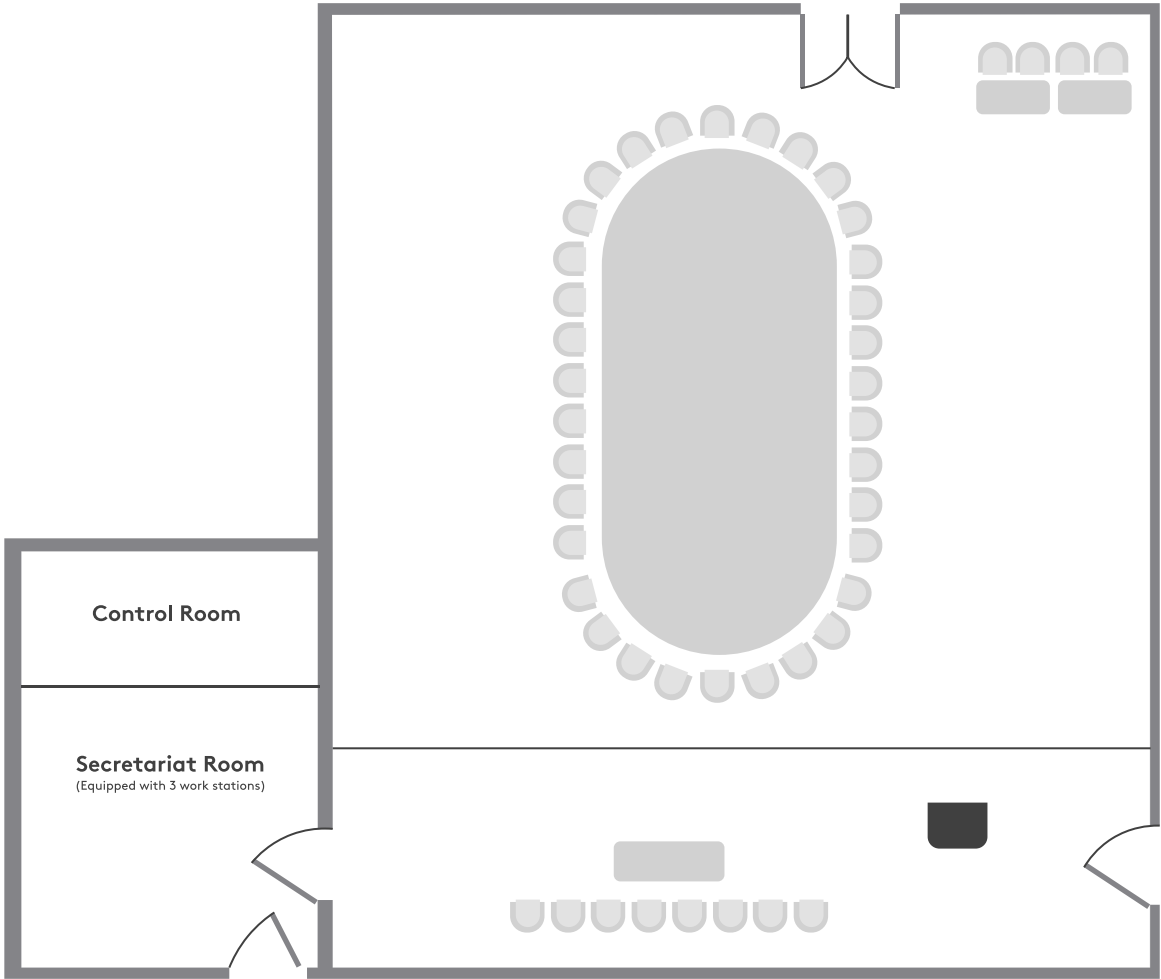

Burunu - Conference Hall



BOARD ROOMS

- 1 - Adha
- 2 - Fura
- 3 - Reyva

02



ADHA

BOARD ROOM

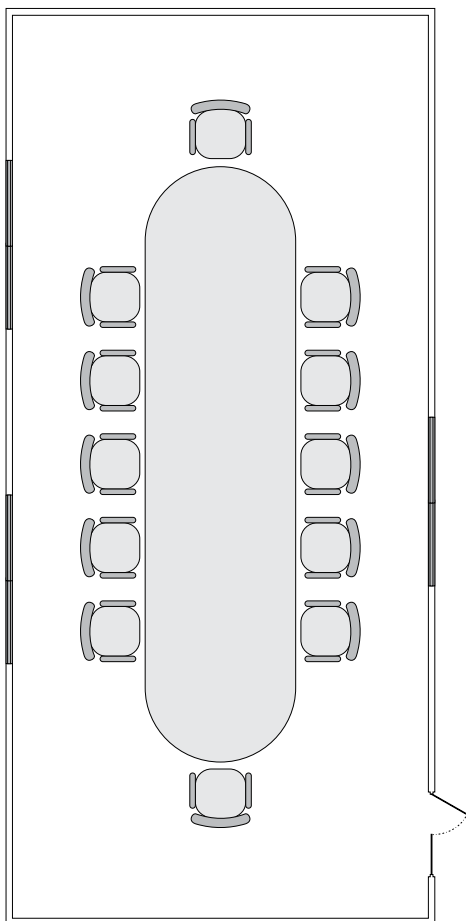

The Adha Boardroom offers an intimate, well-equipped space for up to 14 guests. Perfect for focused meetings and private discussions, this 30 square meter room strikes a balance between comfort and professional ambiance.

Ceiling Height (m): 2.3
Dimension (m): 7.8 x 3.8
Total Space (sqm): 30

FURA

BOARD ROOM

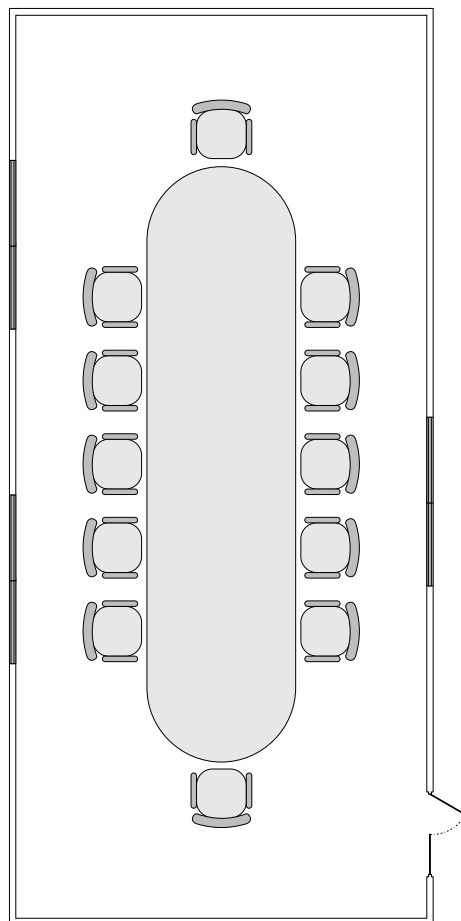

The Fura Meeting Room, slightly smaller than Adha, still comfortably seats 14 guests in a boardroom layout. The space is designed to inspire creativity and foster productive conversations, making it an ideal choice for strategic planning and brainstorming sessions.

Ceiling Height (m): 2.3
Dimension (m): 11.5 x 3.8
Total Space (sqm): 44

REYVA

BOARD ROOM

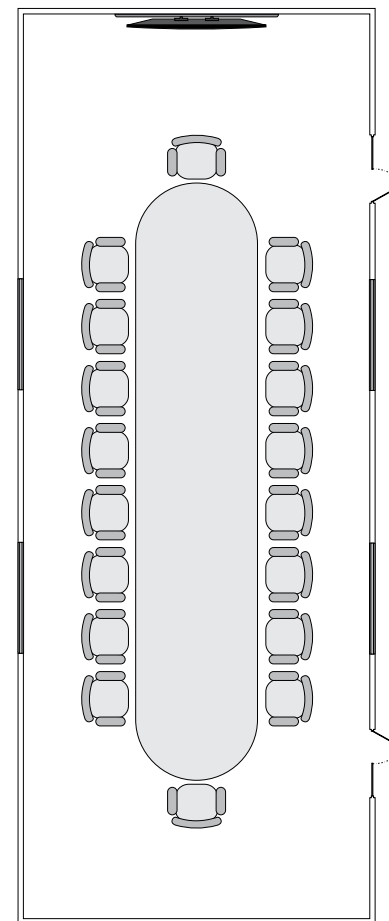

The Reyva Boardroom, our largest boardroom facility, accommodates up to 20 guests within its expansive 44 square meter layout. Perfect for executive meetings or seminars, this space offers comfort without compromising on the professional environment.

Ceiling Height (m): 2.3
Dimension (m): 7.5 x 3.6
Total Space (sqm): 27

Fura - Boardroom



Reyva - Boardroom



VIP LOUNGES

1 - Kethi
2 - Roanu

03

KETHI

VIP LOUNGE

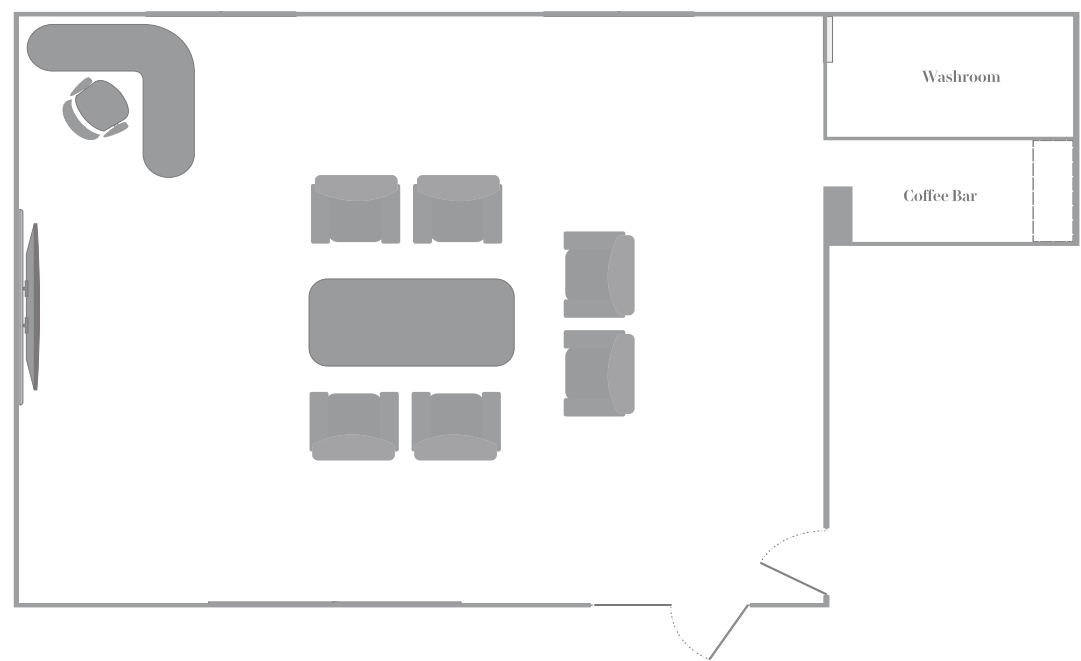

The Kethi VIP Lounge, with its personal coffee bar, is a compact yet luxurious space spanning 39 square meters. Accommodating up to 8 guests, this lounge is perfect for exclusive meetings or intimate social gatherings.

Ceiling Height (m): 2.3
Dimension (m): 6.5 x 6
Total Space (sqm): 39

ROANU

VIP LOUNGE

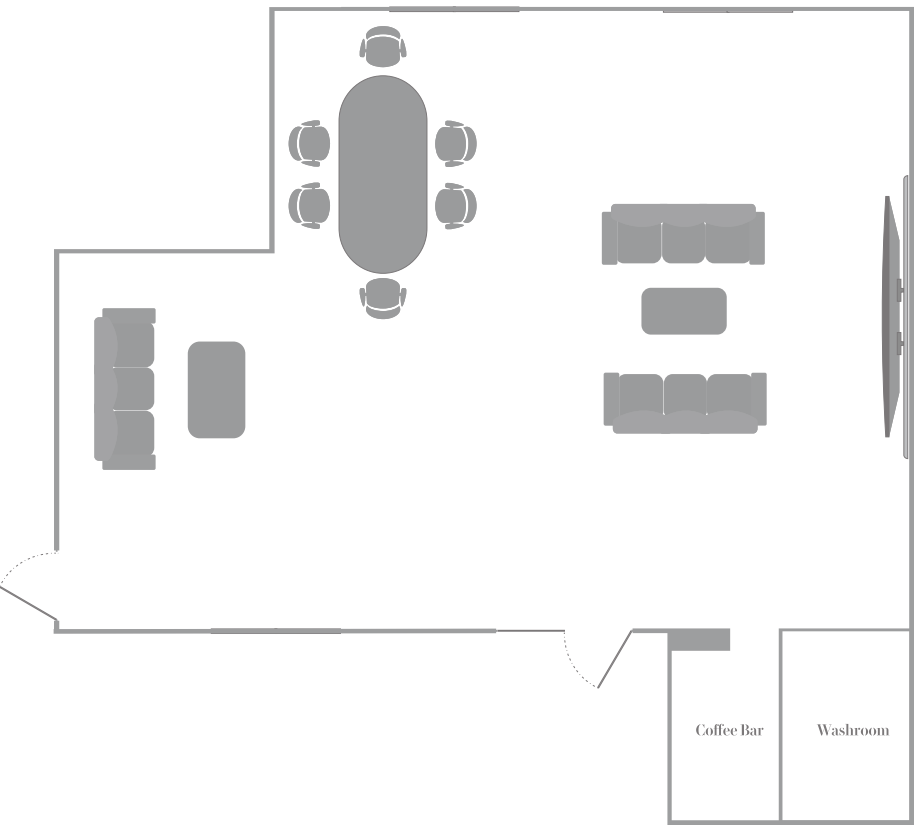

The Roanu VIP Lounge, our larger VIP space, seats up to 18 guests within its 51 square meter area. Offering a relaxed, yet refined setting with a private coffee bar, this lounge caters to both formal meetings and informal interactions.

Ceiling Height (m): 2.3
Dimension (m): 7.7 x 6.6
Total Space (sqm): 51



Kethi - VIP Lounge

Roanu - VIP Lounge



PRIVATE DINNERS
& FUNCTIONS

04

PRIVATE DINNERS & FUNCTIONS

BUSINESS NETWORKING & TEAM BUILDING

Every meeting has its own story, we help you to make it memorable one!

A memorable and enriching meeting and conference can extend well beyond our resort. With the beautiful and serene of Indian Ocean as its backdrop, we are happy to offer customised and personalised themed events tailored to guest preferences, such as the following:

- A private dining
- A Cocktails party
- A wide range of fun filled land and water-based team building activities

These activities are ideal for companies and groups that are looking to break up a long day of meetings to help build camaraderie within the organization. It allows colleagues and teams to bond without feeling the pressure of a working environment.

Add a little excitement to your events and provide memories that will last a lifetime!

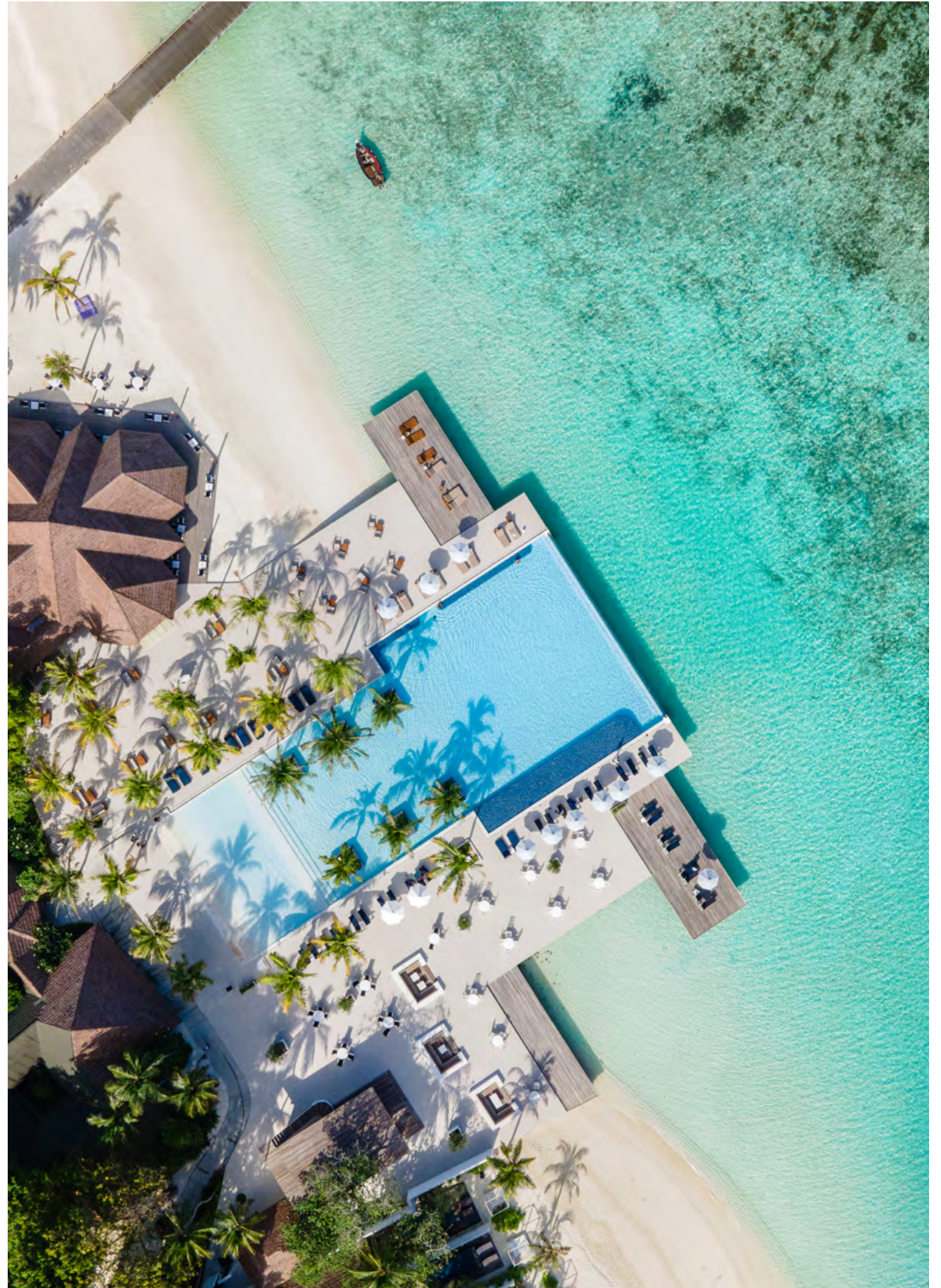



ACCOMMODATION

SEASIDE STAYS

The Quayside Life design philosophy is all about glamour and style with a strong emphasis on the opulent high-life look.

The interiors are contemporary but homely. Crisp blues are complemented by timeless black and white photographs on a feature wall, while carefully handpicked accessories create a chic yet carefree environment.

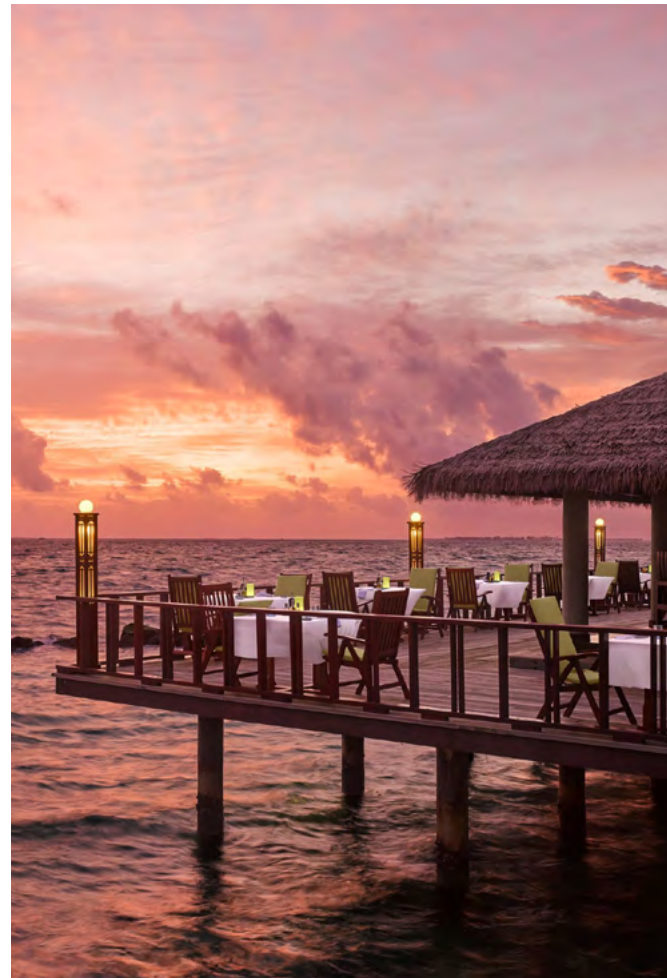

DINING

GLOBAL FLAVORS

Our six superb restaurants showcase global cuisines, including authentic Japanese and Italian-inspired dining.

Our Maldivian dishes are fragrant with traditional spices and we enjoy an abundance of seafood caught by local fishermen in the waters that surround the island. Fresh produce is handpicked daily by chefs from our organic gardens or markets in Malé.

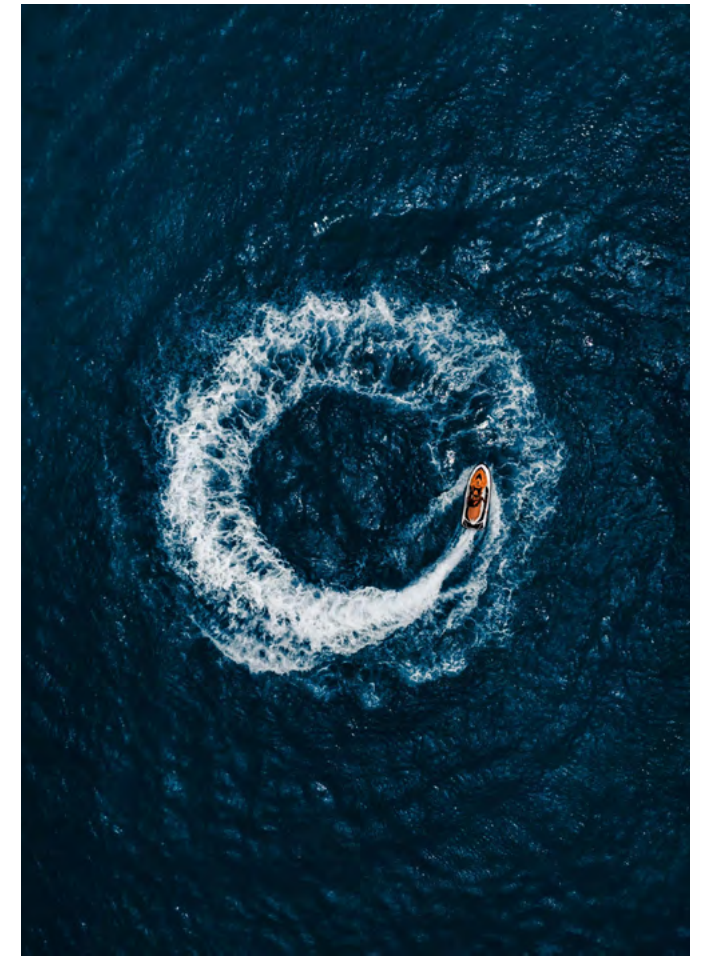











EXPERIENCES

ISLAND ADVENTURES

Immerse in the island lifestyle with curated signature experiences, thrilling water sports, and rejuvenating spa treatments.

Experience award-winning diving, exciting big game fishing, and engage in lively land sports. The Wavy Navy Kids' Club offers a realm of fun for our youngest guests.

MEETINGS & EVENTS SETUP

ROOMS	HEIGHT (m)	DIMENSIONS (l X w m)	AREA (m²)	THEATRE	CLASSROOM	U-SHAPE		BOARDROOM	BANQUET	RECEPTION
										
CONFERENCE FACILITIES										
Dhinasha	3.5	24.5 x 14	343	460	234	74	56 x 2		190	260
Burunu	2.6	17.5 x 11.5	201	243	130	38		34	80	130
BOARD ROOMS										
Reyva	2.3	11.5 x 3.8	44					20		
Adha	2.3	7.8 x 3.8	30					14		
Fura	2.3	7.5 x 3.6	27					14		
VIP LOUNGES										
Kethi	2.3	6.5 x 6	39					8		12
Roanu	2.3	7.7 x 6.6	51			20		18		20

VILLA NAUTICA

PARADISE ISLAND

Villa Nautica, Paradise Island, North Male' Atoll, Maldives
nautica@villaresorts.com | villaresorts.com